

# Prop Shaft Measurement Drawing

**Do not include  
in measurement**

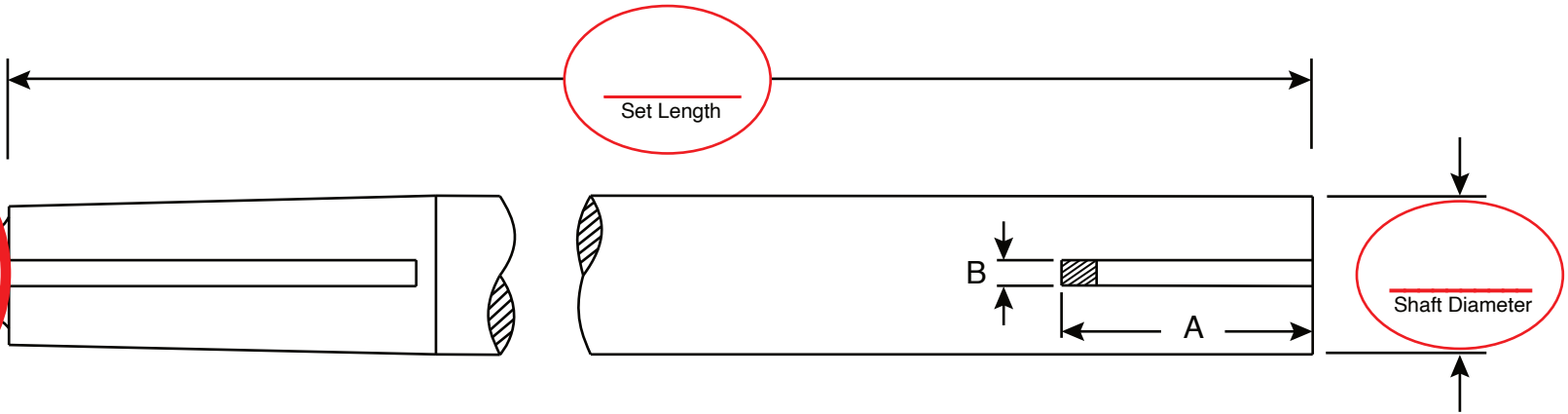
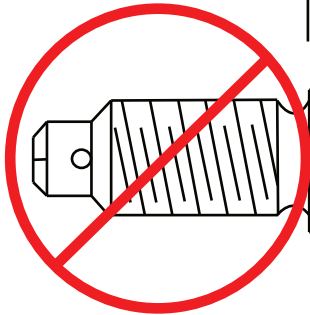

### Measurement Instructions for Boats Without a Shaft:

Measure from aft face of transmission coupler to aft end of cutlass bearing (in strut or stern tube depending on boat model) =  
Base Dimension (BD)  
For 1" shafts: Set Length = BD - 1/4" (for coupler\*) + 1" (for recommended ABYC clearance) + 2-3/4" (for shaft taper)  
For 1-1/4" shafts: Set Length = BD - 1/4" (for coupler\*) + 1-1/4" (for recommended ABYC clearance) + 3-1/2" (for shaft taper)  
\* for Yanmar couplers use 1/2" (1/4" is only for Universal / Westerbeke couplers)

### For Shafts Ordered Without a Coupler:

	Length "A"	Key Size "B"
<input type="checkbox"/> Machine std keyway for 1" shaft:	2-1/2"	1/4" x 1/4"
<input type="checkbox"/> Machine keyway for 1-1/4" shaft:	_____	5/16" x 5/16"
<input type="checkbox"/> Machine non-std keyway:	_____	_____
<input type="checkbox"/> Do not machine keyway in engine end of shaft.		

Boat Model: \_\_\_\_\_ Year: \_\_\_\_\_ Hull #: \_\_\_\_\_ Transmission make: \_\_\_\_\_

Engine Make: \_\_\_\_\_ Engine Model: \_\_\_\_\_ Coupler diameter: \_\_\_\_\_

**Note: Prop shafts are made using the *set length*,  
NOT the overall length.**

*This is a special order item; your order cannot be cancelled or returned once your order is accepted, so please choose and measure carefully. Complete your order by agreeing to these terms and signing at right.*

I, \_\_\_\_\_ certify that the *set length*,  
printed name

*shaft diameter, and keyway dimensions* of the prop shaft as shown in the drawing above are correct.

X \_\_\_\_\_ Date \_\_\_\_\_  
signature